

RSC 6601 Assembly Instruction

1. Safety notes

1.1 Installation and startup

The rotary sensor must be installed by qualified personnel in consideration of all relevant safety regulations.

In case of unauthorized modifications, non-permitted usage or non-observance of installation instructions, the warranty and liability claims will be lost.

All personal protection measures must be taken before startup in case of a sensor defect or failure.

1.2 Electrical connections

The specified supply voltage is to be applied only at the terminals provided.

Non-observance of the pin configuration can result in destruction of the device and loss of warranty.

For a proper function the appropriate combination of male-/female contact material is to be observed.

Recommendation: Check the connections before start of operation!

1.3 Further Information

For further information relating to installation and properties of this product and on available add-on items see also the corresponding data sheet. These can be downloaded under www.novotechnik.de (left-click on "downloads") and are available also from your local representative.

2. Installation

2.1 Terminal diagram

pin configuration:

Pin 1 VDD
Pin 2 Vout
Pin 3 ground

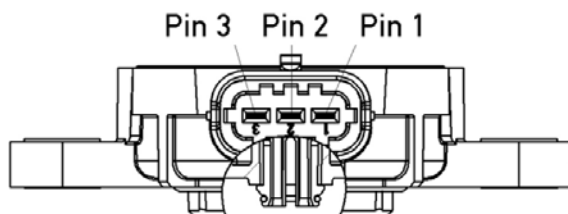

2.2 Output Signal

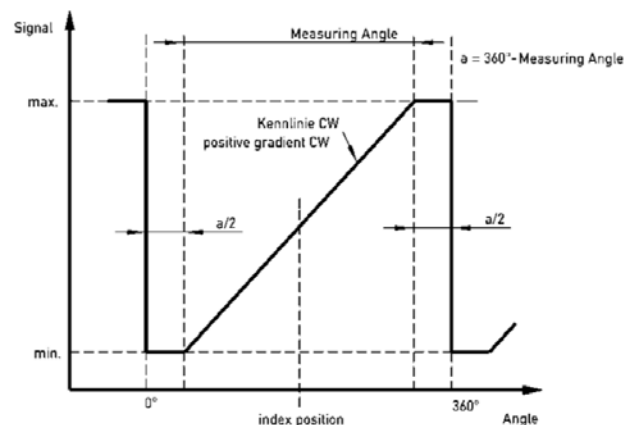

3. Installation Instructions

For a proper sealing the presence and correct position of the O-ring on the sensor has to be ensured before assembly.

Adjust RSC66 by positioning the D-shaft to the contour of the drive blade (see figure 5 and 6). Avoid tilted position of the sensor during assembly.

Push sensor with a maximum force of 100N constantly and parallel on the counter shaft until the end position is reached.

Tighten screws M6 with torque of 8 to 10 Nm.

After disassembly of the sensor the o-ring must be replaced, otherwise the sealing function can not be guaranteed.

RSC 6601 Assembly Instruction

5. Dimensions

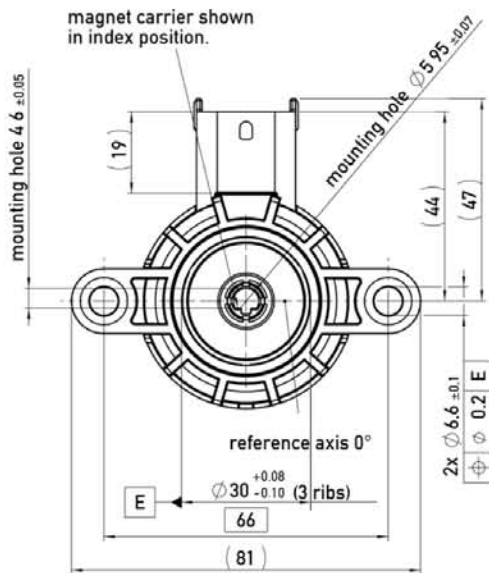
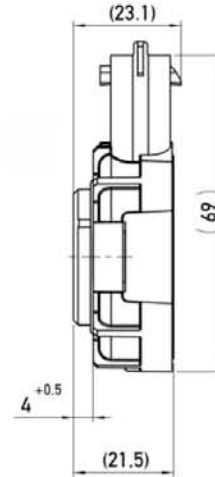
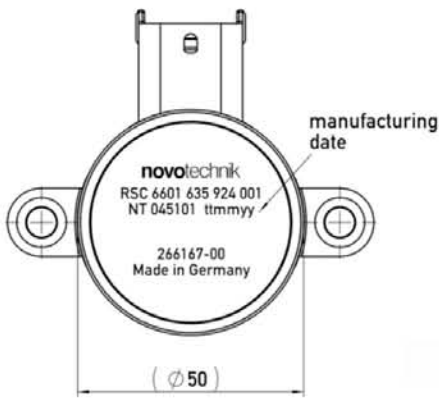

3-way compact interface,
code 1, tin plated, variant A,
acc. to BOSCH interface drawing
1 928 S00 000 sheet 1, 16, 17, 18.

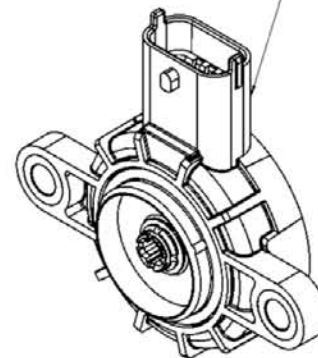

6. Required Mounting Interface

