

Z-RFC-P01/-P02/-P07/-P08

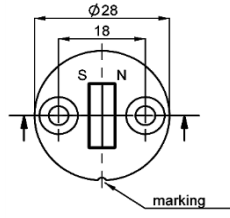

Z-RFC-P01/-P02

Recommended shaft setup

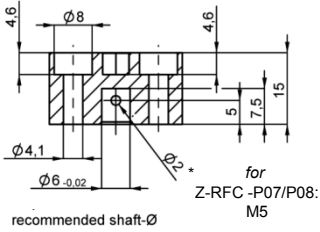
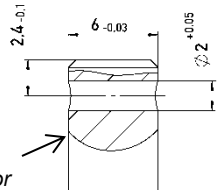

Cross hole for fixation with locking pin

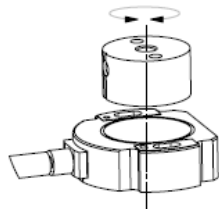

Index position

Installation instructions

Axial mounting with 2 screws M4 x 20, max. tightening torque 300 Ncm
Radial mounting with threaded pin M5, max. tightening torque 120 Ncm

Z-RFC-P30

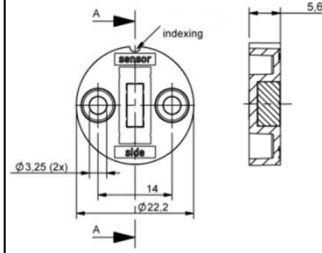

Installation instructions

Axial mounting with 2 screws M3 x 8, max. tightening torque 200 Ncm

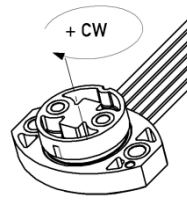

Index position

Z-RFC-P03

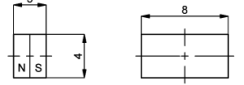

Z-RFC-P04



Installation instructions

Avoid mechanical load. Glue in place with anaerobic glue e.g. Weicon AN 306 30, in not magnetizable material (recomm.)

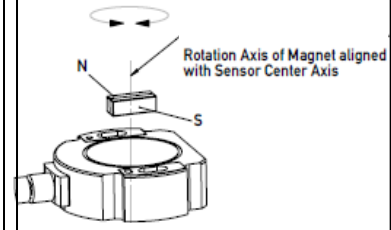

Index position

Z-RFC-P23

Recommended shaft setup

May be without treatment, but a flattening is recommended at screw pressing point for fixation with threaded pin

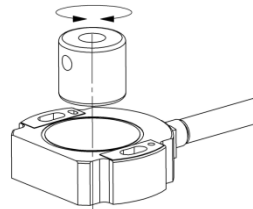

Index position

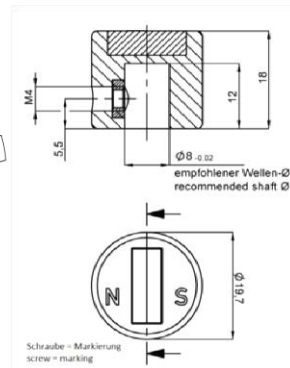

Installation instructions

Radial mounting with threaded pin M4, max. tightening torque 100 Ncm

Z-RFC-P16 Z-RFC-P17

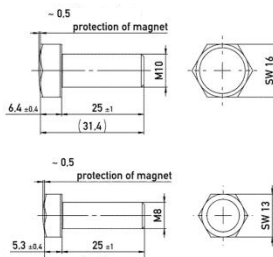

Installation instructions

Directly screwed or secured by mounting nut, tightening torque max. 12...16 Nm. It is absolutely recommended to secure the position marker against rotation.

The orientation of the measuring range (magnet position vs. electrical angle) must be done electronically via output signals.

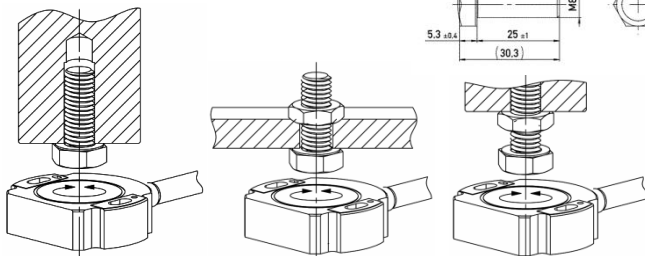

Working distances (in mm) : distance between position marker and sensor housing										
Baureihe series	Z-RFC-P01	Z-RFC-P02	Z-RFC-P03	Z-RFC-P04	Z-RFC-P07	Z-RFC-P08	Z-RFC-P16	Z-RFC-P17	Z-RFC-P23	Z-RFC-P30
RFC analog / digital SPI / single	0 ... 1.5	0 ... 4	0 ... 1.5	0 ... 4	0 ... 1.5	0 ... 4	0 ... 4.5	0 ... 2.2	0 ... 4	0 ... 1.5
RFC analog / redundant	0 ... 1.5	0 ... 4	0 ... 1.5	0 ... 4	0 ... 1.5	0 ... 4	0 ... 4	0 ... 1.7	0 ... 4	0 ... 1.5
RFC digital SSI, Incremental	-	0 ... 1.4	-	0 ... 1.4	-	0 ... 1.4	-	-	0 ... 1.4	-
RFC CAN / IO-Link / single	-	2.3 ... 5	-	2.3 ... 5	-	2.3 ... 5	0 ... 4.5	0 ... 2.2	2.3 ... 5	-
RFC CAN / redundant	-	1.9 ... 4.5	-	1.9 ... 4.5	-	1.9 ... 4.5	0 ... 4	0 ... 1.7	1.9 ... 4.5	-
RFA / single	-	-	1 ... 3	2.8 ... 6.2	-	-	-	-	2.8 ... 6.2	-
RFA / redundant	-	-	0.6 ... 2.6	2.8 ... 6.2	-	-	-	-	2.8 ... 6.2	-
RFD / single	-	-	1 ... 3	2.8 ... 6.2	-	-	0 ... 5	0 ... 2.8	2.8 ... 6.2	1.2 ... 2.7
RFD / redundant	-	-	0.6 ... 2.6	2.8 ... 6.2	-	-	0 ... 4.5	0 ... 2.3	2.8 ... 6.2	0.75 ... 2.25
RFX analog	-	0.3 ... 3.5	-	0.3 ... 3.5	-	0.3 ... 3.5	0 ... 2.5	-	0.3 ... 3.5	-



Lateral offset of sensor and position marker causes an additional linearity error (angular error see data sheet). A concentric mounting has to be ensured.